

QUICK START GUIDE

For Nest Doorbell

- **Suitable for Google Users**
 - ✓ **No Hub Required**
 - ✓ **Easy 5-Minute Setup**
 - ✓ **No Monthly Fees – No Subscription Required**

Hardware Overview

Volume & Pairing



Short Press:

Cycle through 5 volume levels

Hold (5s):

Enter pairing mode (LED flashes red)

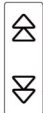

• **Tone Selection:** Next / Previous Chime

Note: To mute the chime, select "Flash-only" mode in the SmartLife App.

Preparation Before Setup

1. Connect to a **2.4 GHz** or **dual-band Wi-Fi** network
2. Keep Google Home and SmartLife app **updated** to the **latest version**
3. Ensure your **Nest doorbell** is fully set up and working in the **Google Home** app (*don't skip this!*).
4. **Download SmartLife App** and create account



SmartLife - Smart Living

Note: Developed by Tuya Inc.



Scan to download

Step 1

Set up in SmartLife

1. Enter Pairing Mode

- Plug in the chime and enable **Bluetooth** on your phone.
- Press and hold the **Volume** button  .
Release when you **hear a pairing tone** or the **indicator light flashes red**.

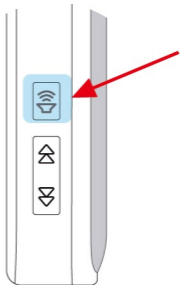
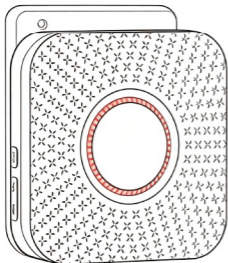

2. Add Device in App

- Open the **SmartLife** app.
- Tap **"+"** (top right) and select **Add Device**.
- Select **Smart WiFi Chime**.
- Enter your Wi-Fi password and tap **Done**.

IMPORTANT NOTE:

This device only works with **2.4GHz** or **dual-band** (2.4/5 GHz) Wi-Fi networks.

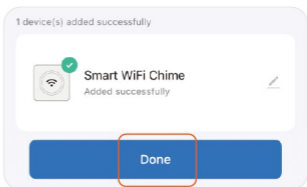
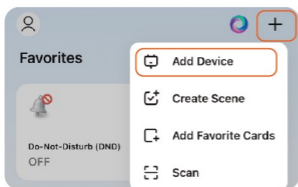

3. Set Up "Tap-to-Run" Shortcut in SmartLife

- Tap "+" (top right)
- **Create Scene** → **Launch Tap-to-Run**
- Tap "+" to add a task → **Device**
- **Select a single device** → **Select your chime.**
- Set **Mode** to your preference and tap Save.
- (💡 Tip: Select "**Flash**" for a silent, visual-only alert.)
- **Name** the shortcut (e.g., "Ring the Chime") and tap **Save**.

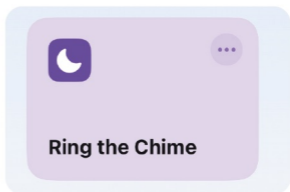
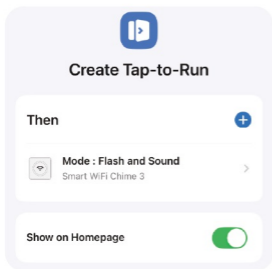

4. Connect to Google Home (App-to-App linking)

- Tap the "**Me**" tab in the bottom menu of the **SmartLife** app.
 - Select **Google** under **Third-Party Service**.
 - Tap **Link to Google** and follow the on-screen prompts.
- No passwords needed!

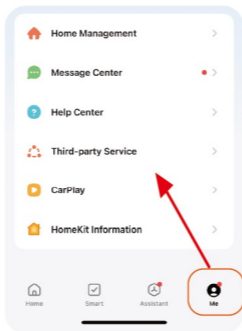

Step 2

Create a Google Routine

Open the **Google Home** app

- Tap **"+"** (top right), then select **Automation**
- Tap the **three-dot menu (⋮)** in top right
- Select **Previous household editor**

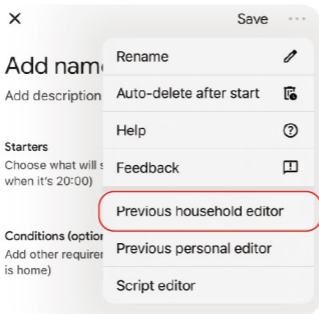

Add Starters (Trigger)

- Tap **+** Add starter
- Select **When a device does something**
- Choose **your Nest doorbell**
- Select **Doorbell rings**, then tap **Add starter**.

Note: You can add optional conditions here, like specific times or days.

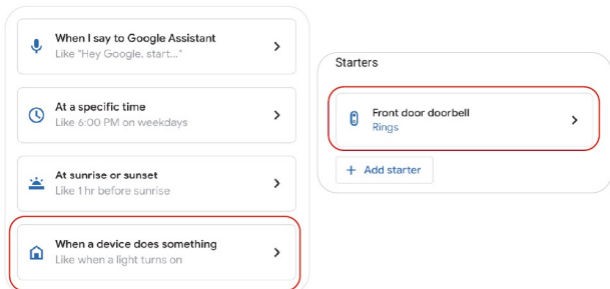

Add Actions (Response)

- Tap **+** **Add action**
- Select **Adjust Home Devices**
- Choose **Add scenes**
- Select **the scene** you created in SmartLife (e.g., "Ring the Chime")
- Tap **Add action** to confirm.

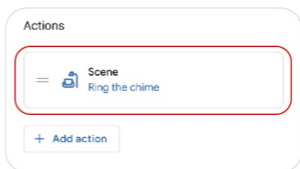
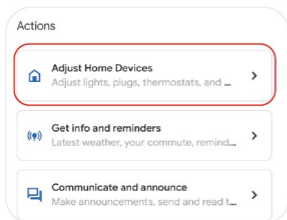

Save and Test

- Tap the **pencil icon** at the top to name your Routine (e.g., "Doorbell Chime").
- Tap **Save** in the bottom right corner.



You're All Set!

Go to your front door and press your doorbell. Your new Smart Wi-Fi Chime should now ring simultaneously!

Expand Your Coverage

Need a chime in the garage or upstairs?

You can add up to 99+ chimes to a single doorbell.



Here is how:

1. Ensure your first Chime is fully set up and working.
2. Add the new Chime to the **SmartLife** app then **Create a new Scene**.
3. Open the **Google Home** app and find your existing Doorbell Routine.
4. Scroll down to **Actions**, tap **+ Add action**, and select the **new Scene** you just created. Save the Routine.

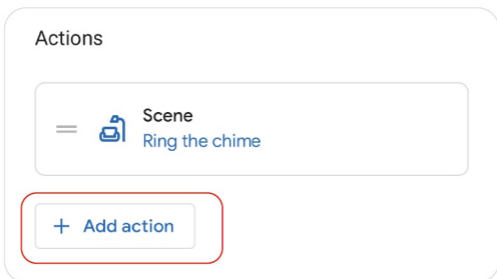

💡 Pro Tip: Custom Melodies

You can set a different melody for each Chime.

This way, you'll know exactly which room is ringing!