

QUICK START GUIDE

For Ring Doorbell

- ✓ No Echo Speaker Required
- ✓ Easy 5-Minute Setup
- ✓ No Monthly Fees – No Subscription Required

Hardware Overview

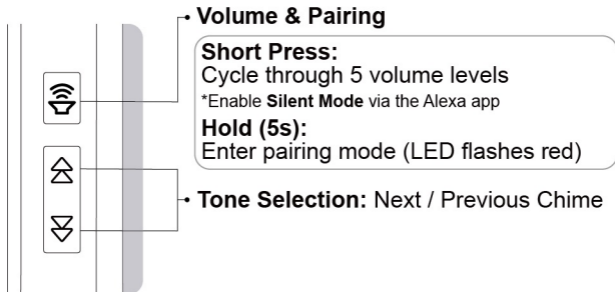

How Your Chime Works



Quick Start Guide

- ✓ Step 1: **Set up in SmartLife**
- ✓ Step 2: **Link Your Video Doorbell to Alexa**
- ✓ Step 3: **Create an Alexa Routine**

IF: Doorbell Pressed → THEN: Chime Sounds

Step 1

Add the Chime to SmartLife & Link to Alexa

1. Enter Pairing Mode

> Plug in the chime and enable **Bluetooth** on your phone.

> Press and hold the **Volume** button  Release when you hear a **beep** and see a **flashing red light**



2. Add Device in App

Open the **SmartLife** app

> Tap "+" (top right) > Add Device

> Select **Smart WiFi Chime**

> Enter your Wi-Fi password and tap **Done**

(⚠ Note: **Only works with 2.4GHz or dual-band 2.4/5 GHz Wi-Fi**).

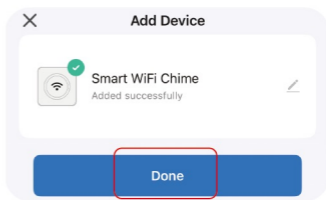
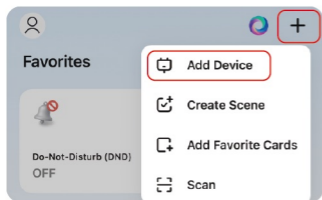

3. Rename Your Chime

> Tap your added **chime** > Tap **Device Edit** (bottom left)

> **Rename**



Recommended Name

Rename it to **"Indoor Chime"**

Avoid using **"Doorbell"** (may confuse Alexa)

4. Authorize Alexa Linking

Tap the **Settings icon** (⋮) in top right

> Tap **Third-party Control** > **Alexa** > **Link to Alexa**

> Follow prompts to finish



✔ All Set! You will see a "Linked" status on the screen.

Step 2

Link Your Ring Doorbell to Alexa

Open your **Ring** app:

1. Tap **Menu** ☰ in the top-left corner
2. Tap 👤 **Account Settings**
3. Select 🔵 **Ring Alexa Skill**
4. Tap **TURN ON RING SKILL**
5. Tap **AGREE AND CONTINUE**
6. Tap the blue **LINK** button.

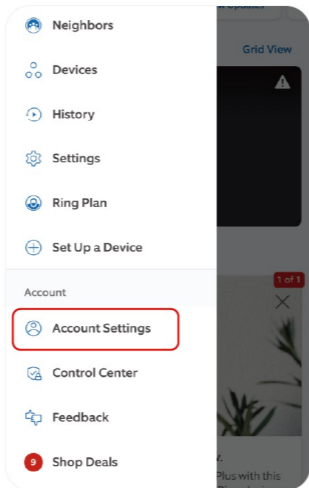

✔ Done! Status will change to “Linked”

Step 3 Create an Alexa Routine

(Final Step!)

Open your **Alexa** app

(1) Start a New Routine

Tap **More** (≡) > **Routines** > Tap **+** (top right)

(2) When this happens: ("My Ring Doorbell " is pressed.)

Tap **+** Add an event > Tap **Smart Home**

> Select **👁** your **Ring video doorbell**

> Tap **Doorbell** > Tap **Save**

NOTE: Choose your actual **Video Doorbell** here.

⚠ Heads up: Make sure you don't accidentally select the chime!

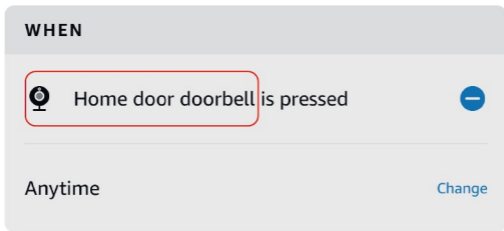

💡 **Pro Tip:** Tap "Anytime" to change it to a specific schedule, like "Active only during the day."

(3) Alexa Will: (Play sound on "Indoor Chime".)

Tap  Add an action

> Tap **Smart Home** > Tap **Doorbells**

> Select  **the Chime** you named in SmartLife (e.g., "Indoor Chime")

⚠ Do NOT select your video doorbell here!

> Tap **Alert Mode** and choose **what you need**.

(💡 **Tip:** For **silent mode**, select "**Flash Only**".)

> Tap **Next** in the top right corner

⚠ **Note:** Make sure to select the Chime here, NOT your doorbell

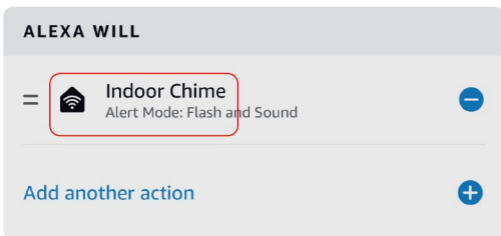

(4) Save & Test

Tap "**Save**" at the bottom.

✅ Setup is complete! Go press your doorbell to test it.

FAQs

? Q: *I followed all the setup steps, but the chime still won't work. What should I do?*

A: Don't worry! The most common issue is usually a missed setting in the **Alexa Routine**. To get this fixed quickly, please scan the QR code to access our **Troubleshooting Guide**.



Scan for troubleshooting tips

? Q: *Is a subscription required?*

A: 100% Subscription-Free.

Our device is designed to work fully out of the box without any monthly costs. While the app might suggest premium plans for Cloud Storage or SMS/Phone notifications, these are strictly optional. Feel free to skip these prompts and enjoy all the chime's features at zero extra cost.

? Q: *How do I ensure I downloaded the correct app?*

A: Please ensure the app is named "**Smart Life-Smart Living**" (Developer: **Tuya Inc.**) and features a blue house icon.



Scan to download

? Q: *Is there a delay between the doorbell press and the chime ringing?*

A: **Wired doorbells:** Nearly instant.

Battery-powered doorbells: Expect a 3-5s delay. This is standard for most battery-powered video doorbells. To conserve power, the doorbell must "wake up" before sending a signal. This 3–5 second interval is a built-in battery protection mechanism of the doorbell itself and does not indicate an issue with your Chime Pro.

? Q: *I can't connect the Chime to my Wi-Fi. What should I do?*

A: Don't panic! Most modern US routers combine 2.4G and 5G into one Wi-Fi name, and your phone prefers 5G.

The Fix: Plug the chime into an outlet farther away from your router and stand there with your phone. 5G signals are short-range, so walking away forces your phone to connect to the long-range 2.4G signal. Once paired, you can move the chime anywhere!

Expand Your Coverage

Need a chime in the garage or upstairs?
You can add up to 99+ chimes to a single doorbell.



Here is how:

1. Ensure your First Chime is fully set up and working.
2. Add the New Chime to the **SmartLife** app.
⚠ Important: Give it a unique name (e.g., "Upstairs Chime") so Alexa doesn't get confused.
3. Open your existing **Routine** in the **Alexa** app.
Under the "**ALEXA WILL**" section, tap **+ Add another action** to include the new Chime.

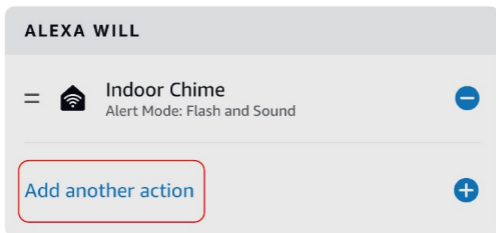

💡 Pro Tip: Custom Melodies
You can set a different melody for each Chime.
This way, you'll know exactly which room is ringing!